

Hudson Valley Plaza

701 Frank Sottile Blvd, Kingston, NY 12401



Hudson Valley Plaza

701 Frank Sottile Blvd,
Kingston, NY 12401

JOIN



PROPERTY HIGHLIGHTS

- » 17,418 SF space available with 20' ceilings, ideal for a fitness gym or outdoor/active lifestyle retailer, expandable by 67,000 SF
- » Situated in Ulster County's main retail corridor, adjacent to Hudson Valley Mall
- » Positioned in a busy retail center with major anchors like Walmart, Lowe's, and Sam's Club, ensuring steady customer traffic
- » Located at heavily trafficked 4-way signalized intersection on U.S. Route 9W and Frank Sottile Boulevard off of the U.S. Route 209/199 and Interstate-87 (NYS Thruway) interchange

DEMOGRAPHICS

Drive Time	Population	Daytime Population	Households	Average Household Income	Median Household Income	Per Capita Income
10 min	30,110	29,735	12,818	\$71,147	\$57,434	\$30,556
15 min	57,356	48,962	24,694	\$80,320	\$64,743	\$34,882



Kingston, NY

Hudson Valley Plaza

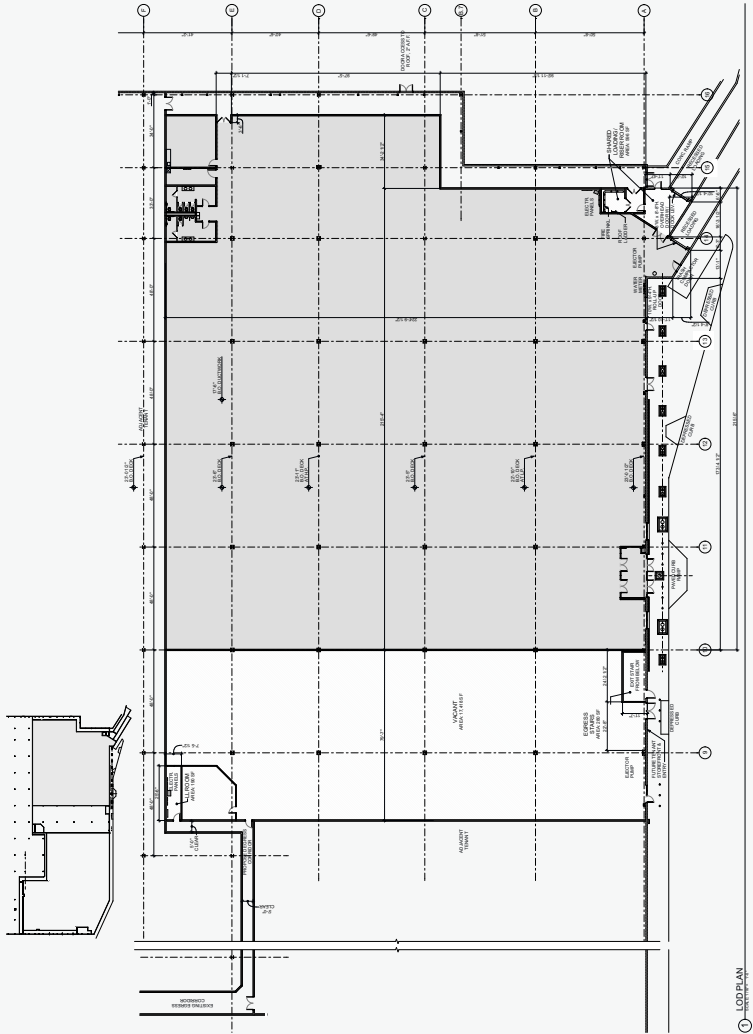



Hudson Valley Plaza

Kingston, NY



Hudson Valley Plaza

199





17,418 SF

EXPANSION OPPORTUNITY
67,000 SF



Residence Inn
by Marriott

HUDSON VALLEY MALL
 TARGET  NCG CINEMA

LEASED
AVAILABLE

CRAZY BOWLS
 CRAZY BOWLS
 VALOR HEALTH CARE
 VALOR HEALTH CARE
 PYLON

ULSTER AVE

Kingston, NY

Hudson Valley Plaza



CONTACT:

Julie Fox | Vice President, Retail Leasing

443.835.5862

jfox@mcbrealestate.com



www.mcbrealestate.com