

Hudson Valley Plaza

701 Frank Sottile Blvd, Kingston, NY 12401



Hudson Valley Plaza

701 Frank Sottile Blvd,
Kingston, NY 12401

JOIN



PROPERTY HIGHLIGHTS

- » 17,418 SF space available with 20' ceilings, ideal for a fitness gym or outdoor/active lifestyle retailer, expandable by 67,000 SF
- » Situated in Ulster County's main retail corridor, adjacent to Hudson Valley Mall
- » Positioned in a busy retail center with major anchors like Walmart, Lowe's, and Sam's Club, ensuring steady customer traffic
- » Located at heavily trafficked 4-way signalized intersection on U.S. Route 9W and Frank Sottile Boulevard off of the U.S. Route 209/199 and Interstate-87 (NYS Thruway) interchange

DEMOGRAPHICS

Drive Time	Population	Daytime Population	Households	Average Household Income	Median Household Income	Per Capita Income
10 min	30,110	29,735	12,818	\$71,147	\$57,434	\$30,556
15 min	57,356	48,962	24,694	\$80,320	\$64,743	\$34,882



Hudson Valley Plaza

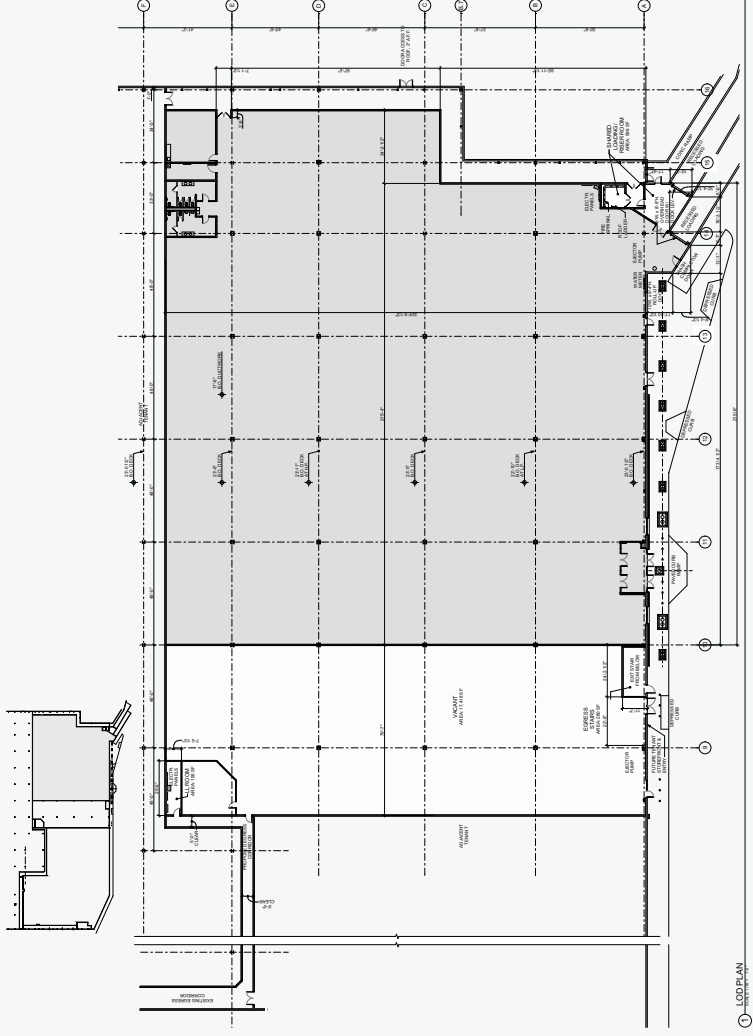

Hudson Valley Plaza

Kingston, NY



Hudson Valley Plaza

199

DICK'S
SPORTING GOODS

17,418 SF

ASHLEY
FURNITURE
HOMEWARE

CLUBS
SPORTS CENTER

EXPANSION OPPORTUNITY
67,000 SF

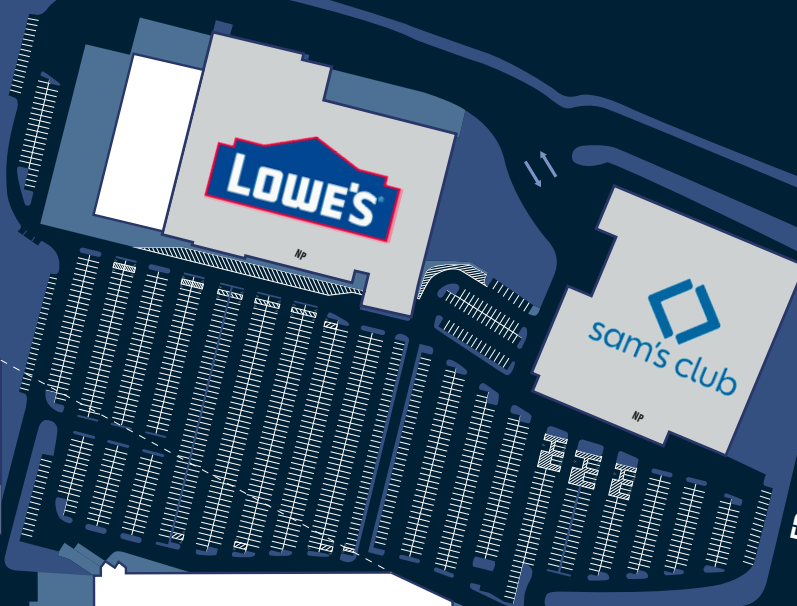

FRANK SOTTILE BLVD

Residence INN.
BY HAWORTH

Walmart
Save money. Live better.

PET SMART

Raymour
& Flanigan
FURNITURE NP

HUDSON VALLEY MALL
TARGET NCG
CINEMA

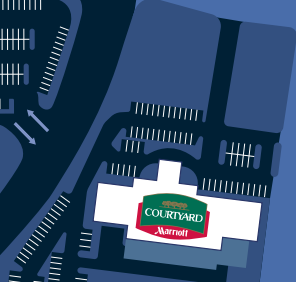

LEASED
VACANT

209

CRAZY BOWLS

VALOR HEALTH CARE

PYLON

ULSTER AVE

Kingston, NY

Hudson Valley Plaza



CONTACT:

Adam Rabin | Vice President, Retail Leasing

240.497.0520 ext. 153

arabin@mcbrealestate.com



www.mcbrealestate.com